

一字型支架 一shaped bracket

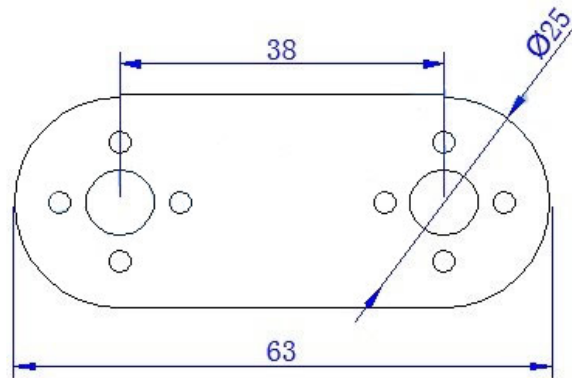

Specification

Material: 2mm hard aluminum plate

Surface treatment: sandblasting oxidation

Size: 25X63mm

Weight: 16g

Color: silver white or black

Suitable to Korea HS322, HS422, Fraser MG995, MG996, SG5010 servos, Hitec, Parallax, Futaba, Towardpro brand (the size of about $40 \times 20 \times 36$ mm) standard servos.

CNC machine tool manufacturing of the bracket hole bit error is plus or minus 0.1mm sheet metal angle error of 5 degrees, and the sheet metal bends error of 0.5 mm material for the 60 series of hard aluminum plate 2mm thick, high hardness, light quality, very high precision technology .

規格

材料：2mm 硬鋁板

表處：噴砂氧化

尺寸：25X63mm

重量：16g

顏色：銀白色

適合韓國的 HS322、HS422，輝盛的 MG995、MG996、SG5010 等舵機，支持 Hitec、Parallax、Futaba、輝盛等品牌（尺寸為 $40 \times 20 \times 36$ mm 左右）標準舵機。

本支架數控機床製造，孔位元誤差為正負 0.1mm，鈹金角度誤差為 5 度，鈹金彎位誤差為 0.5mm，材料為 2mm 厚的 60 系列硬鋁板，硬度高，品質輕，工藝精度非常高。